

OUR BUILDING PLANS

Groundbreaking Ceremony: Saturday, May 16 at 4:00pm



Master Building Plan

April 12, 2009

After three years of research, planning, and reflection, we are very please to announce the groundbreaking for Phase I of St. Cecilia Parish Master Building Plan for Saturday, May 16, 2009 at 4:00pm.

Phase I of the master building plan is the construction of a new activity center to provide a worship space during the church renovation in Phase II. The Activity Center drawing and details can be found on page 2 of this

struction vehicles and staging of the Activity Center build. This will provide the least impact to daily and weekend traffic.

Phase I includes the remodel of the old gym in the school (see page 3 for



details) into a preschool, cafeteria/meeting room, and music room. There is also an addition to the kindergarten space and a new science classroom.

Phase II will be the expansion of worship space to the old church (see page 4 for details), a conversion of the church nave into a parish hall, and the addition of meeting spaces adjacent to the church. Phase II will also bring our parking lot up to code with the addition

of 188 parking spaces. The playground will be moved to the southwest playing field in Phase II.

Future master plans include a bell tower, appliances for the catering kitchen, covered walkways and playground, and relocating the Parish Office to the Parish Center (across the street).

Larger drawings of the plans in this issue can be found on our web site at:

www.stceciliachurch.org

| Phase I | Phase II | Future |
|-------------------------------------|-------------------------------|--------------------------------|
| 1. Activity Center | 6. Church Expansion | 11. Covered Play Area |
| 2. Science Lab | 7. Remodel of the Parish Hall | 12. Catering Kitchen Build Out |
| 3. Kindergarten Expansion | 8. Meeting Rooms | 13. Covered Walkway |
| 4. Preschool, Music Room, Cafeteria | 9. Parking Lot Expansion | 14. Bell Tower |
| 5. Parking Lot expansion | 10. Playground Renovations | 15. Parish Office Relocation |

The master building plan encompasses both a short and a long term plan to meet the needs of our parish. The objective is to provide more space for our ever growing programs, particularly for the growing number and size, of our religious educational groups, bible studies, community outreach programs, and social activities.

document. Phase I will also provide the first level of expanded parking. The exit from parking to Tucker Ave. will be closed and a new exit onto 8th Street will be opened along with parking spaces. The ball field on the southeast side of the property will remain in Phase I and the playground will not move. The ball field on the southwest side will be used for con-

OUR BUILDING PLANS

Activity Center

Phase I begins on May 16 with the groundbreaking of the Activity Center. The activity center is 132 feet (East to West) and 86 feet (North to South). The gymnasium floor, made of maple wood, measures 96 feet x 76 feet for a regulation size basketball or volleyball court and two practice side courts. The space can accommodate

650 people at a sit down dinner, 600 people at a buffet dinner, and 750 people in stadium seating for stage presentations.

The catering kitchen will be used for Mother's Day Brunch, Summer Picnic, St. Cecilia Festival, Crab Feed, large funeral receptions, Spanish Dance, and other events that attract more than 200 people.

The catering kitchen is located on the east side of the building, adjacent to the parking lot, allowing easy access for deliveries.

Plans provide for a 922 square foot (20' 6" X 56' 8") catering kitchen that has been plumbed for future hookups for several ovens, griddle, stove, sinks, refrigerators, and a dishwasher. Pantry storage, storage for tables and chairs, and the temporary cover we plan to lay over the gym floor to protect it during dining events has been provided, including double doors for easy access.

The concessions space in the lobby remains accessible for all sporting events and small functions.

The activity center will have a pull out stage on the north wall. This stage will be used for performances, but can also double as an altar for Mass during Phase II construction. The restroom and locker room facility is located at the west side of the activity center, along with additional storage, a PE office, and a janitorial storage space.

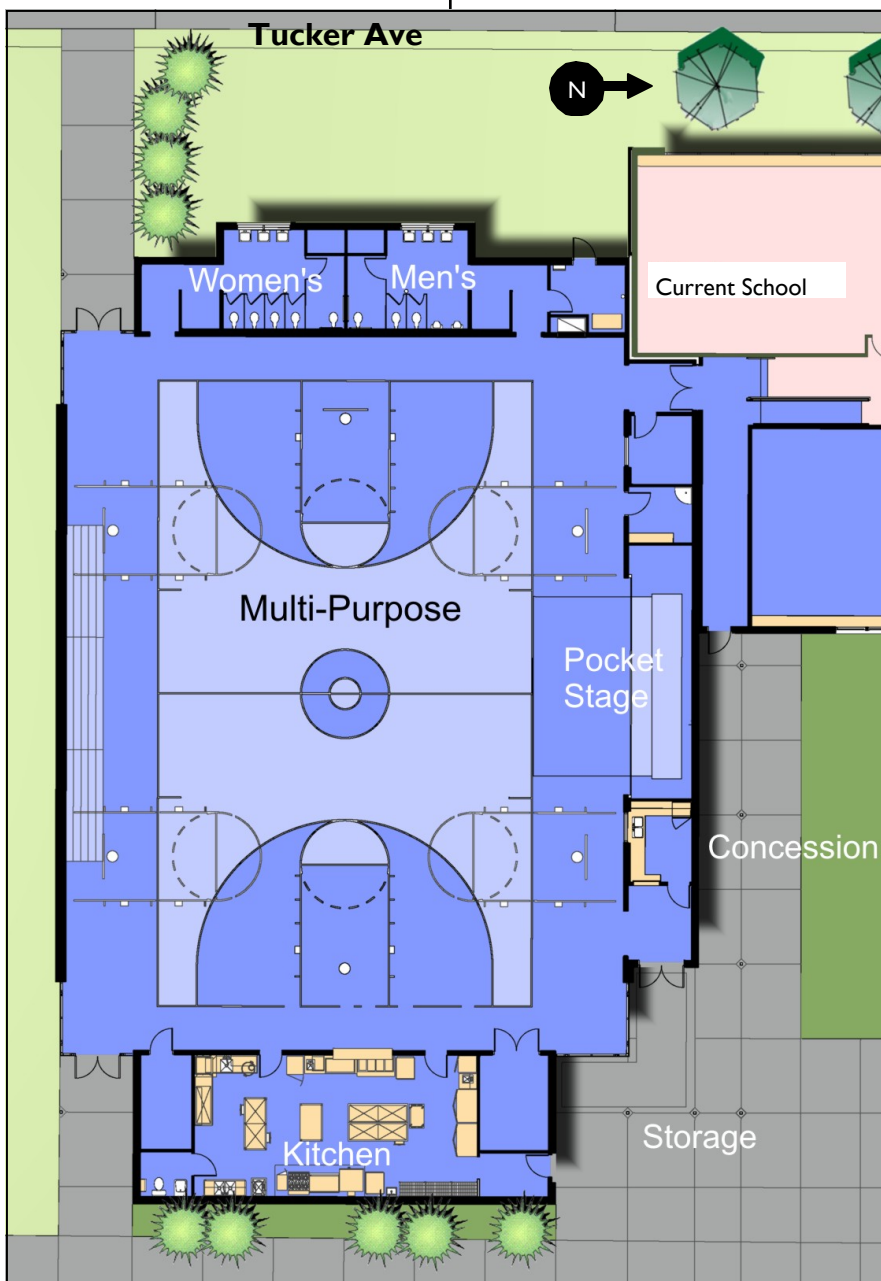

Past Issues of *Our Building Plans* and **larger drawings of the drawings in this issue** can be found on our web site at

www.stceciliachurch.org

Past Issues of *Our Building Plans*:

- *Building in a Tough Economy*
- *Additional Outside Funding Sources*
- *The Gift of Prayer*

Master Building Plan

School Remodel

The construction on the school will begin June 12, 2009 and completed during the summer of 2009.

The old gym will be remodeled to accommodate a cafeteria/meeting room. It will be used by the school during the day and in the evening for youth and adult Religious Education groups. The preschool (currently in the Parish Center) will be moved to a new classroom space in the school. This will free up two rooms in the Parish Center for meeting use by youth group and other ministries.

The preschool will be divided into two areas: classroom space and early childhood play centers. The childhood play centers will be open for Religious Education classes, including Sunday Preschool, as well as childcare for various adult groups that meet in the evenings.

The music room will replace the area now occupied by the stage. This room will triple the size of the current music room. It will be utilized by the

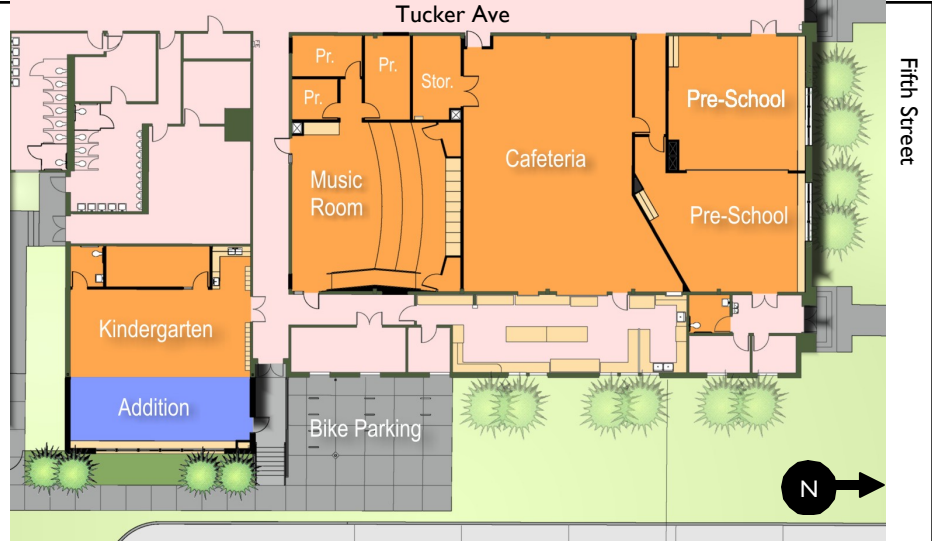

school during the day for class and evenings and weekends by all parish choirs for practice and warm-up before Mass. Storage space for music groups will be provided and additional funding is being sought to add individual practice rooms (noted as P.R. on the drawing above).

The Kindergarten will be expanded during the summer of 2009 to increase the room by 50%, taking it from 872 square feet to 1,403 square feet. You may remember that our kindergarten program went from 15 students part-time to 30 students full time. The additional space will provide the necessary space to meet the needs of a full day program.

The science lab will be added to the existing middle school wing in the school. This classroom permanent space will replace our current science lab on a cart. The classroom will be used by all students in K-8 for experiments and

labs as well as the middle school for daily lecture and lab space. The classroom provides lab tables for 32 students, a demonstration table for the instructor, sinks, computer terminals, aquarium, and significant storage under cabinets and in closets. This room will be completely funded by a grant from Murdock Foundation. We have received preliminary acceptance of our grant proposal and are anxiously waiting their final decision on funding.

Funding

Our current Capital Campaign has raised \$2,421,000 in pledges. Our goal is to receive an additional \$329,000 in pledges for Phase I. We are 9 months into a 3 year pledge payment program and have received over \$800,000 in contributions. An additional \$75,000 has been received from other donors and memorial gifts for a total of \$875,000 Cash on Hand, putting us ahead of schedule for collections.

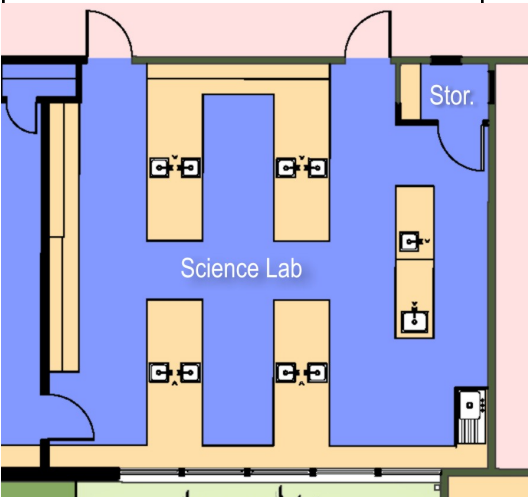

Master Building Plan

Phase II

Phase II of the master building plan will begin in 2010. Major remodel of the old church includes a new 850 seat worship area, expandable to 1,200 seats in the future. The Adoration Chapel will be located within the new Church behind the altar. By relocating it within the new church, we eliminate duplicate Tabernacles on campus, give our chapel greater visibility for our larger community to recognize, and attract more people to this prayerful practice.

The church will include a Bride's Room/Server Room, Sacristies, and adequate rest rooms and storage. The narthex or entry will adequately provide space for visiting with others and preparing children for Mass.

The nave or main section of the existing church will be remodeled to a Parish Hall, providing seating for 250 persons for funeral receptions, coffee and donuts, and wedding receptions. The kitchen adjacent to the parish hall will provide cooking areas for these events. An expanded restroom facility designed to serve the church, meeting rooms and Parish Hall will also be completed.

Meeting Space Addition

Three conference rooms will be included in and connected to the new Church addition. These rooms can host any number of the many volunteer and ministry groups, including

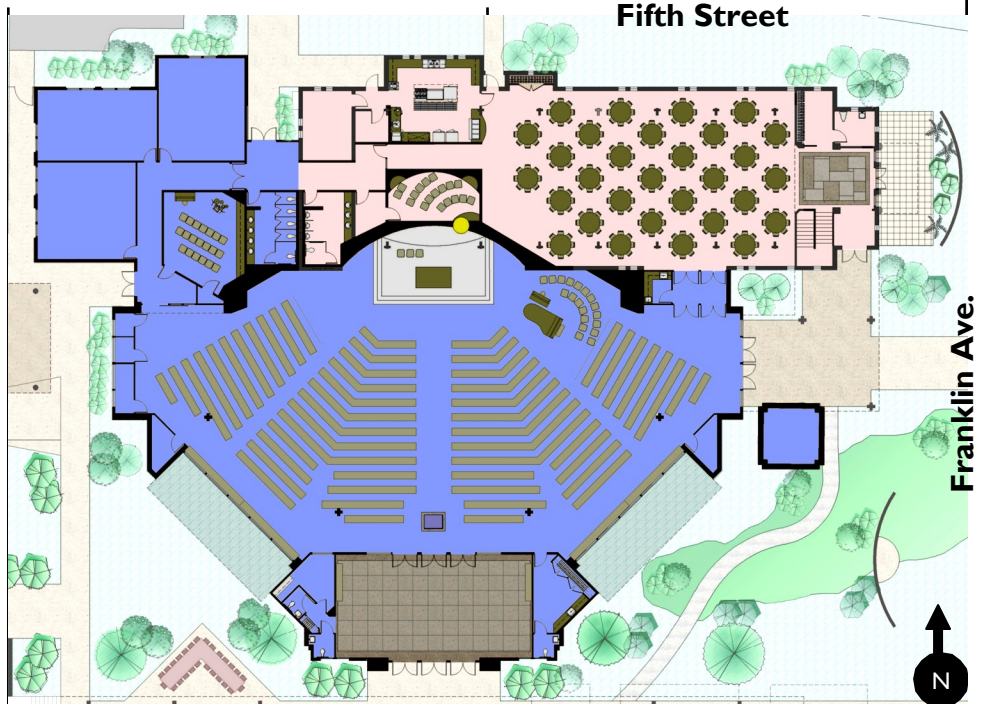

Children's Liturgy of the Word. Our children will no longer need to leave the Church to receive their Liturgy of the Word, creating a safer and more cohesive sacred experience. RCIA will find a permanent place in the meeting rooms, providing an expanded program for adult faith formation.

Parking Lot Completion

The southeast field will be replaced in Phase II with 188 additional parking spaces, and a new top coat will be provided for the entire parking area. The playground will be moved to the southwest play field along with updated play structures.

As we continue to free up meeting space, a new youth center will be permanently placed in the Parish Center, providing a space for our growing high school and middle school religious

education programs.

Funding for Phase II will include the sale of Parish owned property on Murray Blvd. and capital campaign pledges from parishioners and donors. Numerous gift opportunities for Phase II include stained glass windows, pews and religious art for the church and grounds.

Future Plans

Our master plans include future opportunities to grow the parish with a bell tower, covered playground, covered walkways, catering kitchen build out, and relocating Parish Offices to the Parish Center.

Larger drawings of the plans in this issue can be found on our web site at:

www.stceciliachurch.org